

Model: S10-IP-Tuya

## IP 10.1 inch Indoor Monitor ( IPS Glass Lense )



### Key Features:

**Simplified Wiring:** CAT 5 / CAT 6 network cable connection, supporting long-distance communication.

**Remote Access:** Remote video talk and remote unlock via Tuya and Smart-life app.

**Record:** Supports up to 128GB Micro SD card for storing photos and videos.

**Intercom System:** call to other apartment indoor monitors, call to guard station and monitor door station

# IP 10.1 inch Indoor Monitor ( IPS Glass Lense )



Indoor Monitor	
Operation system	Linux operation system
Display screen	10.1" IPS Glass HD Screen
Display resolution	1280 * 800
Audio input	1 microphone, pickup distance $\leq$ 0.5 meters
Audio output	1 speaker
Audio intercom	Two-way audio communication
Audio quality	Noise suppression and echo cancellation
Communication Mode	IP
Tranmission Signal	TCP/IP
Distance	$\geq$ 100 meters
Connection	Network cable, CAT 5 / CAT 6
WiFi	2.4G WiFi
Mobile App	Tuya or Smart life app
Language	English, Russian, Ukrainian, Polish, Portuguese, Arabic, Hebrew, French, German, Spanish, Italian, Czech, Turkish
Ringtone	10 Ringtones
Memory card	Max 128GB Micro SD card
Record	Photo / Video record
CCTV Camera	20 IP Cameras via ONVIF protocol
Power supply	DC 18V 1A / POE / Customized internal power transformer(AC 110V-240V)
Power consumption	$\leq$ 6 W
Working humidity	10% to 90%
Color	Black + Silver Edge
Materials	ABS plastic + Glass Mirror / Fireproof material when using internal power
Accessory	Bracket (include)
Dimension (L x W x H)	245 mm * 163 mm * 25 mm
Installation	Surface mounting / Wall-mounted

CE FC RoHS

# IP 10.1 inch Indoor Monitor ( IPS Glass Lense )

Size:

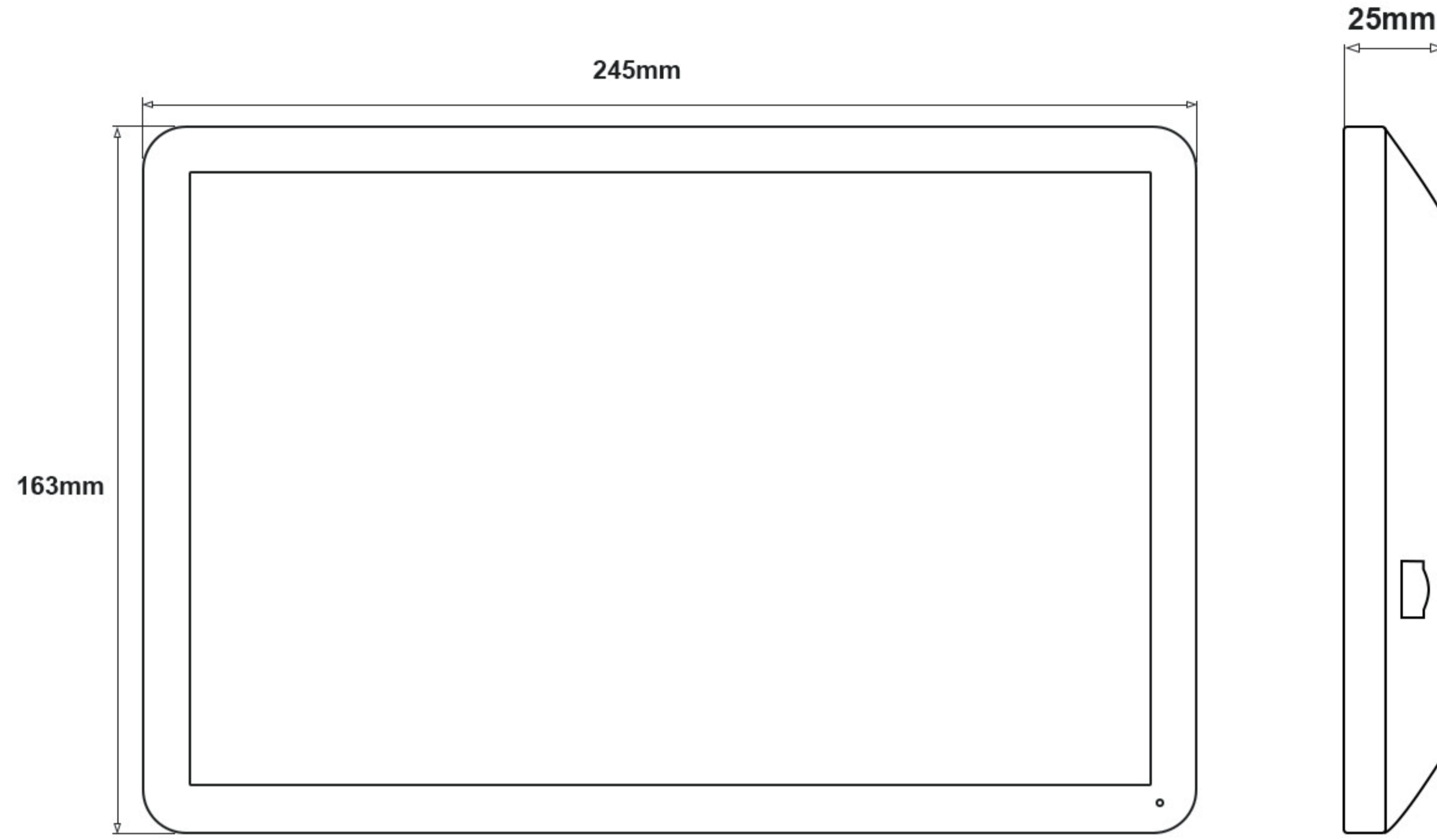

## System Diagram:

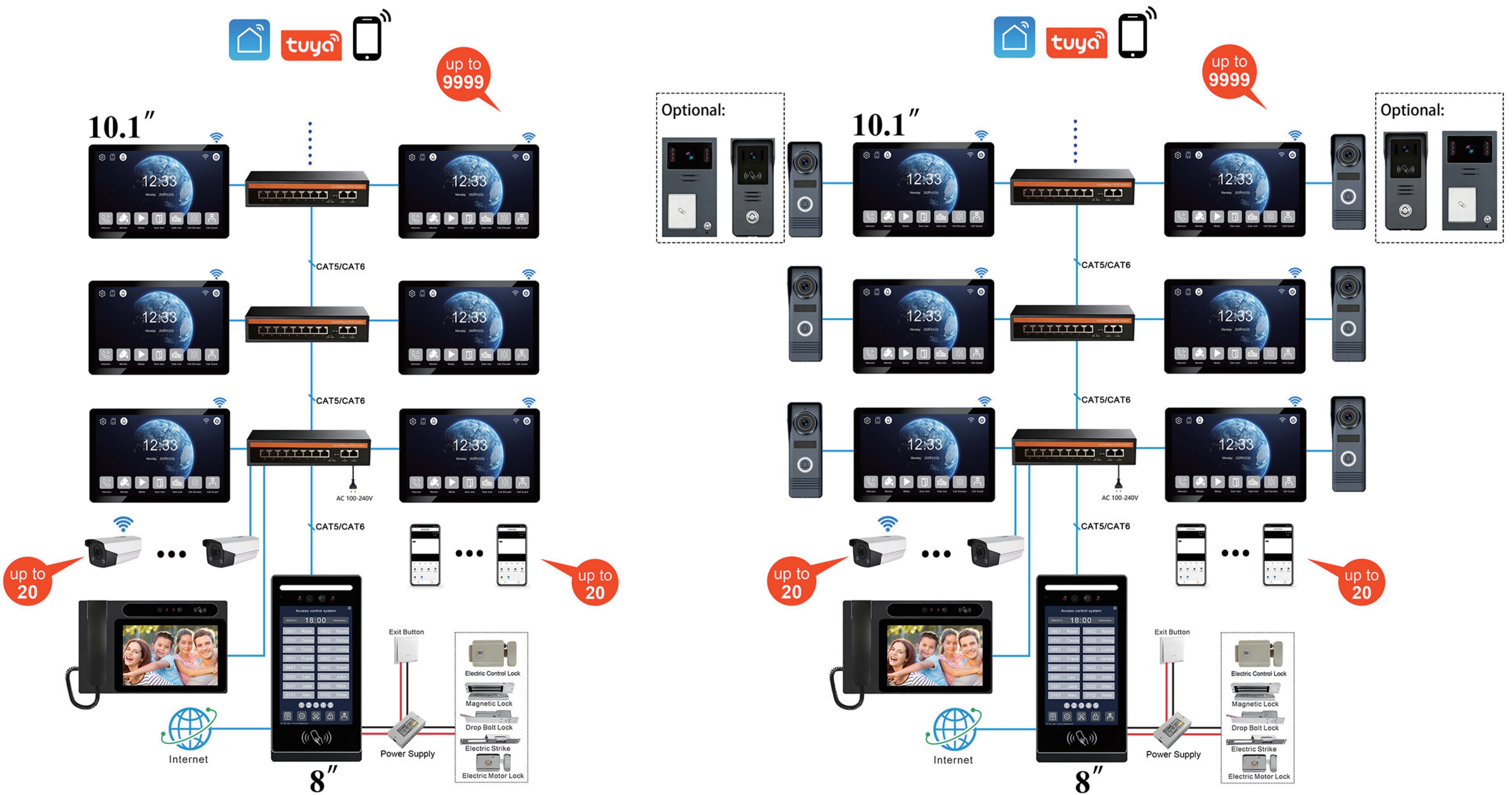

CE FC RoHS

## What's Included in the package?



Indoor Screen Package \* 1



Indoor Monitor \* 1

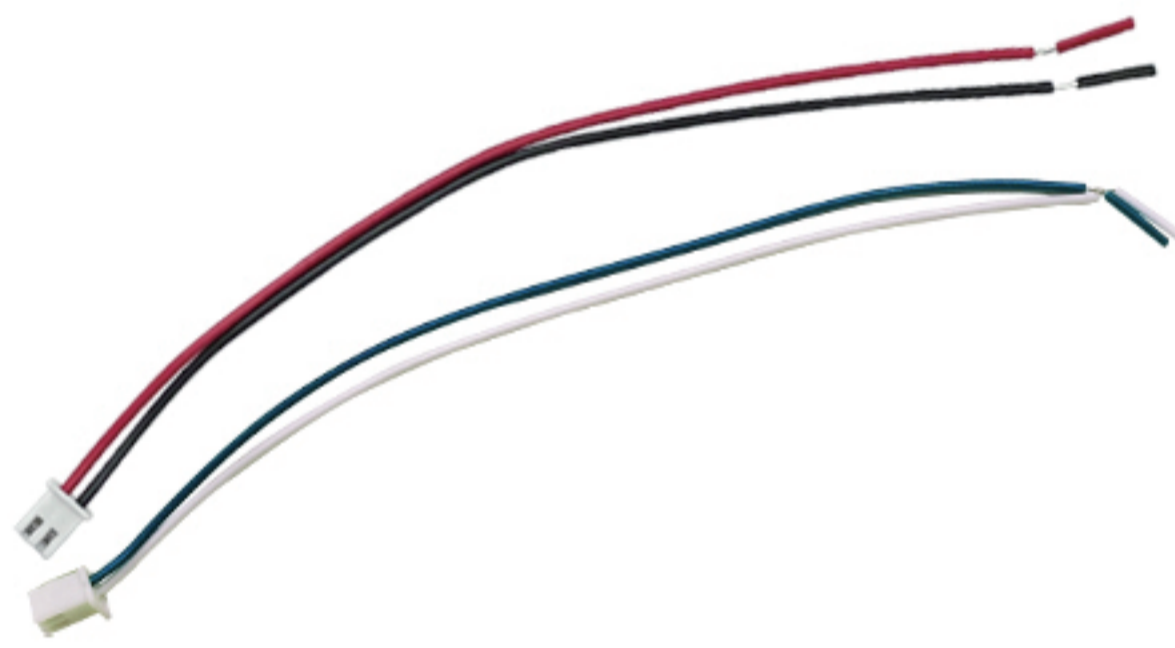

Connector \* 2



Screw+Rubber Stopper \* 4

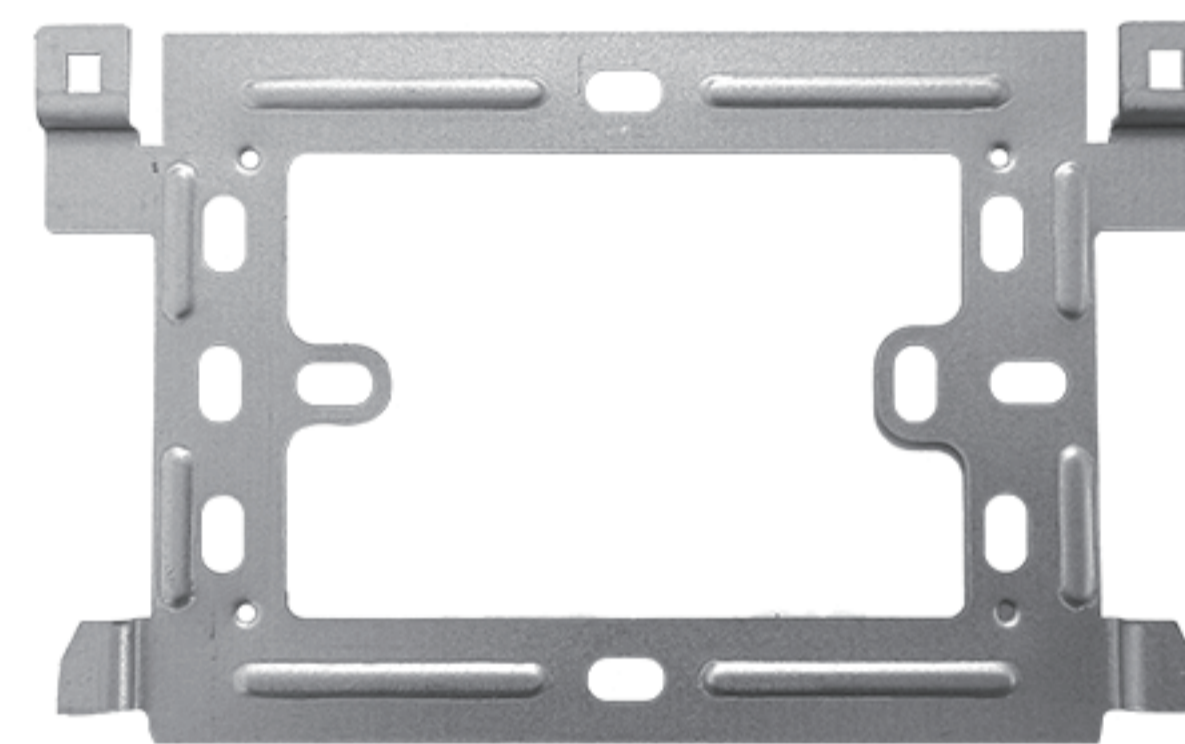

Hanging iron \* 1



User Manual \* 1

### Manufacturer

Floor 6 Sanhe Science and Technology, Sanhe Road.Dalang Street, Longhua District, ShenzhenCity, Guangdong Province, China

Mob: +86 188 2370 9809

Email: [info@farhd.com](mailto:info@farhd.com)

[www.farhd.com](http://www.farhd.com)

CE FC RoHS